

CIRCA

Round Linear Light



Applications: Offices, education and healthcare, government, corporate, retail

PERFORMANCE SUMMARY

Designed from the ground up as a modern retake of a classic shape, the Circa's signature round shape and direct, indirect/direct beam options make it a desirable choice for establishments looking for feature lighting that is unique as it is visually comfortable

Circa can be used as a single luminaire or individual runs that can also be equipped with a louver option to reduce glare and provide light where it's needed.

Construction

- Nominal 3.4"W housing fabricated from heavy-gauge extruded aluminum
- Full linear portfolio of nominal 2'4"/8' lengths to design an entire space
- Interchangeable mounting detail for sheetrock or various tile grid ceilings
- Pendant installation employs aircraft cables that can be connected end to end with 2 different canopy options
- Sealed optical compartment rated for damp locations
- Gray, black or white trim colors complements every decor
- Five stage phosphate bonded powdercoat finished in textured baked enamel
- Configurable for individual or continuous runs of up to 40'
- Aircraft cable can be adjusted along the length of the fixture to match existing mounting points.

Optical

- Shielding attachments provide reduced glare and added uniformity
- Multiple light output options for just the right amount of light
- Available in UGR<19 louver lens
- 5 CCTs 3000k to 3500k, 4000k, 4500k, 5000k
- Batwing uplight distribution with a single horizontal LED array allows for wider spacings at higher efficiencies

Electrical

- AC120-347V or AC347-480V Class II/P Driver
- Enhanced ultra smooth dimming down to 5% compatible with most Lutron and Leviton 0-10V controllers
- Integrated internal occupancy sensor system
- Average rated life L80: >60,000H
- Operating Temperature: -22°F to 104°F
- SDCM: <5 PF: <0.95 CRI: > 82

PERFORMANCE

Shape	600 Lumens Per Ft ¹			900 Lumens Per Ft ¹			1150 Lumens Per Ft ¹		
	Wattage	Efficacy	Lumens	Wattage	Efficacy	Lumens	Wattage	Efficacy	Lumens
2' Linear	10	115	1,200	16	115	1,800	20	115	2,300
4' Linear	21	115	2,400	31	115	3,600	40	115	4,600
8' Linear	42	115	4,800	63	115	7,200	80	115	9,200

¹Initial delivered lumens at 25°C (77°F). Actual production yield may vary between -10 and +10% of initial delivered

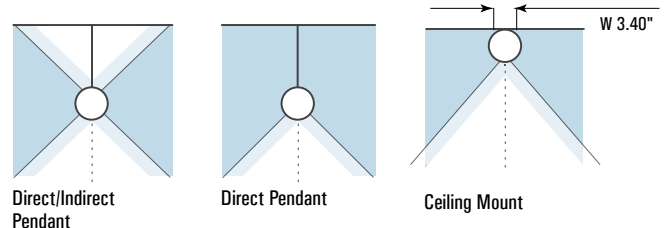
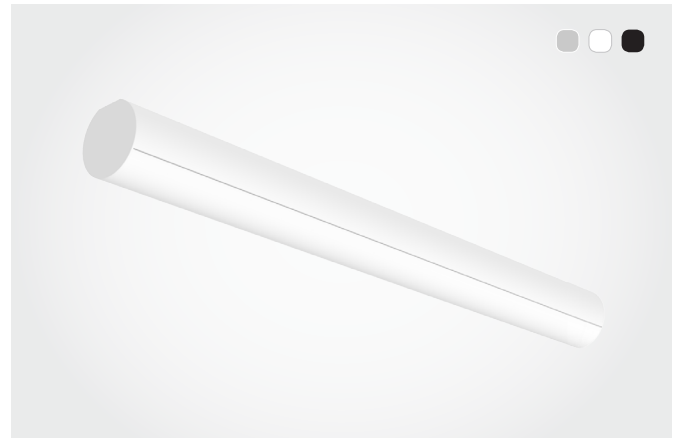

Shielding



D
Diffuser



LV
Louver

Cross Section

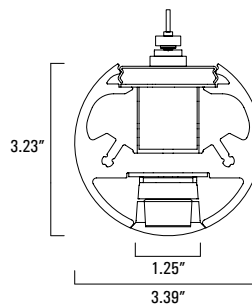

CIRCA

Round Linear Light

PRODUCT CODE

Example Circa cat. 600.600.345.30.0.W.0.P.STL8.H.5.0.0.0

Model No	Voltage	Length	Direct Output	Indirect Output	Direct CCT	Indirect CCT	Finish	Lit Joints ¹
Circa	120 - 120-347V	2 - 2ft	600 - 600 Lumens Per Ft	600 - 600 Lumens Per Ft	345 - CCT Selectable	345 - CCT Selectable	G - Gray	L - L-Shape
		4 - 4ft			3/4/5000	3/4/5000	B - Black	0 - None
	480 - 347-480V	8 - 8ft	900 - 900 Lumens Per Ft	900 - 900 Lumens Per Ft	30 - 3500	30 - 3500	W - White	
			1150 - 1150 Lumens Per Ft	1150 - 1150 Lumens Per Ft	35 - 3500	35 - 3500		
			xxx - Custom Lumens Per Ft	xxx - Custom Lumens Per Ft	40 - 4000	40 - 4000		
					45 - 4500	45 - 4500		
					50 - 5000	50 - 5000		
				0 - None	0 - None			

Mounting	Pendant Kit	Ceiling	Canopy	Sensor	Emergency	Shielding	Accessories
C - Ceiling W - Wall	0 - None	0 - None	0 - None	M - Motion Sensor RC - Remote Control for Sensor	EM - 8W/90min Emergency 0 - None	LV - Louver D - Diffuser 0 - None	PS - 25/50/75% Power Selectable 0 - None
P - Pendant	STL - 8' AC cord and Aircraft Cable Kit STLx - Custom Length AC Cord/Aircraft Cable Kit (Specify 'x')	T - T Grid H - Hard Ceiling	5 - 5" dia Round Canopy 0 - None	0 - None			

NOTES

¹For shape specification please provide diagram as shown on next page

²Consult factory for DLC options

DIMENSIONS

Linear

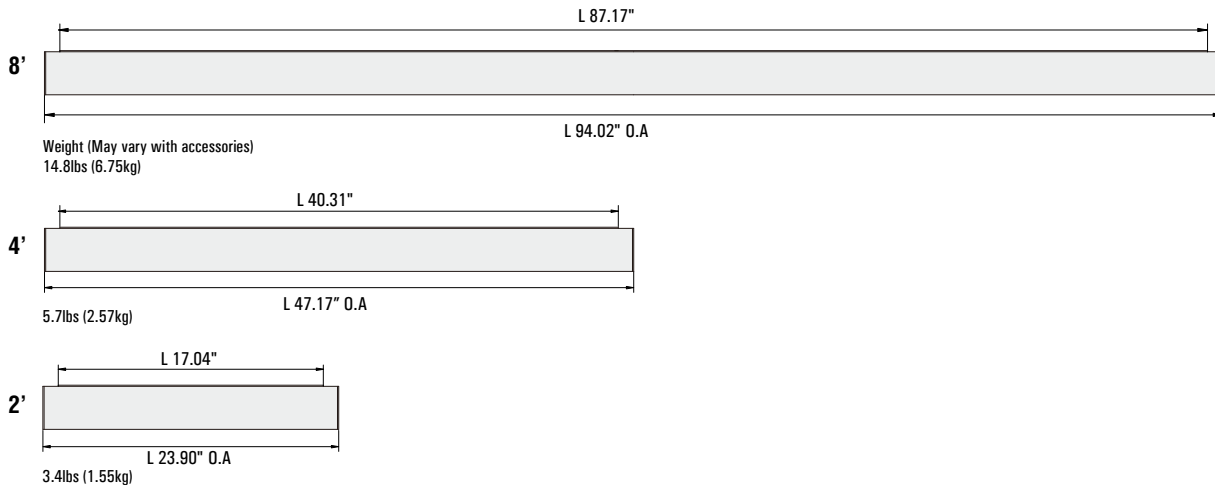

CIRCA

Round Linear Light

INTERNAL SENSOR COVERAGE

Side View

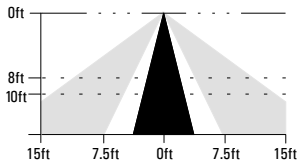

Top View

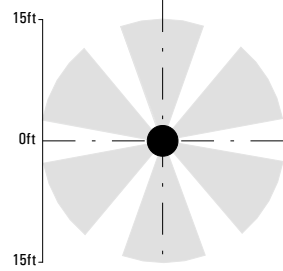

NOTE Installation of integrated sensors within 3ft of HVAC air vents is not recommended. The pattern shown is intended as a general guide and is not to scale.

PHOTOMETRICS

Direct/Indirect

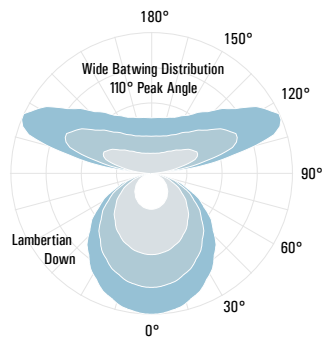

Direct

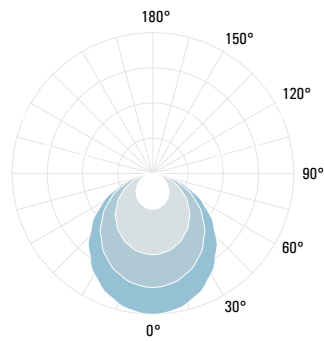

LINKAGE

Circa made is made up of 2, 4 or 8 ft runs that can be linked together in any combination for a required length output, refer to linking diagram adjacent. Each run must be noted on the specification code or drawn for geometric shapes other than continuous runs. Minimum sections available 2ft

Our joining mechanism is strong and robust, employing an internal linking connectors that lock both fixtures in place with a clasp and lock mechanism structure resulting in a tight connection with no light leakage in any direction

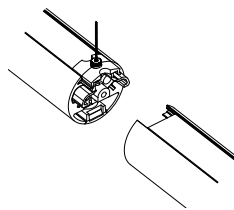

Joining system for Circa direct/indirect

JOINTS

For shape please draw your layout sketch as below including linear lengths on all sides, part no and square/rectangle shape with 90° joints only, or consult factory for a detailed quotation

Shape Diagram

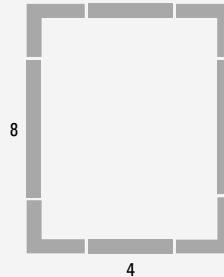

Eg. Circa Type A

300 300 30 45 G C
Direct Indirect Direct Indirect Finish Mounting
Output Output CCT CCT

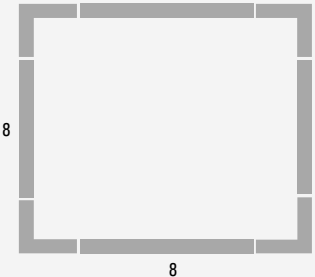

Eg. Circa Type A

cat. 300.300.30.45.G.C

Single

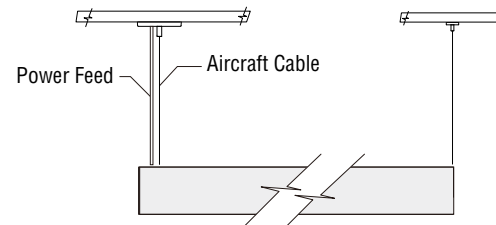

Continous

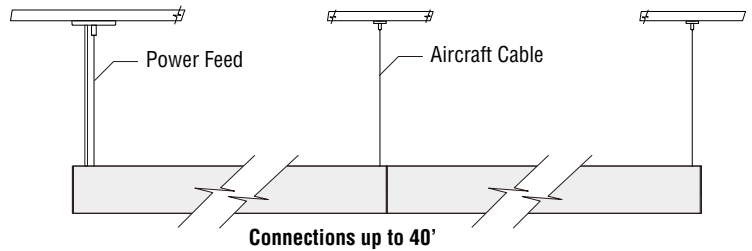

CIRCA

Round Linear Light

MOUNTING DETAIL

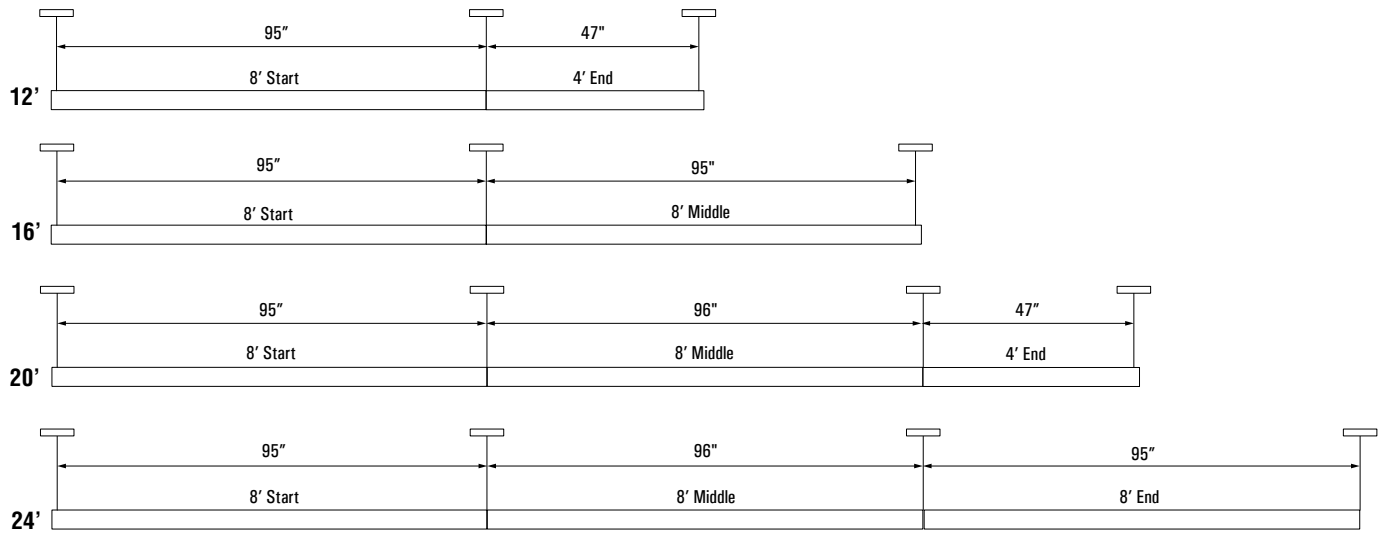

NOTE

Consult factory for additional row mounting information